



Retrofit option

ON WAK xx5
ON WAK tigSpeed

Wheel assembly kit

General instructions

CAUTION



Read the operating instructions!

The operating instructions provide an introduction to the safe use of the products.

- Read the operating instructions for all system components!
- Observe accident prevention regulations!
- Observe all local regulations!
- Confirm with a signature where appropriate.

NOTE



In the event of queries on installation, commissioning, operation or special conditions at the installation site, or on usage, please contact your sales partner or our customer service department on +49 2680 181-0.

A list of authorised sales partners can be found at www.ewm-group.com.

Liability relating to the operation of this equipment is restricted solely to the function of the equipment. No other form of liability, regardless of type, shall be accepted. This exclusion of liability shall be deemed accepted by the user on commissioning the equipment.

The manufacturer is unable to monitor whether or not these instructions or the conditions and methods are observed during installation, operation, usage and maintenance of the equipment.

An incorrectly performed installation can result in material damage and injure persons as a result. For this reason, we do not accept any responsibility or liability for losses, damages or costs arising from incorrect installation, improper operation or incorrect usage and maintenance or any actions connected to this in any way.

© EWM AG · Dr. Günter-Henle-Str. 8 · D-56271 Mündersbach, Germany

The copyright to this document remains the property of the manufacturer.

Reprinting, including extracts, only permitted with written approval.

Subject to technical amendments.

1 Contents

1	Contents	3
2	Safety instructions	4
3	Overview	5
3.1	Proper usage.....	5
3.1.1	ON WAK xx5.....	5
3.1.2	ON WAK tigSpeed.....	5
3.2	Example applications.....	6
4	Machine description – quick overview	7
4.1	ON WAK xx5.....	7
4.2	ON WAK tigSpeed.....	8
5	Assembly	9
5.1	ON WAK xx5.....	9
5.2	ON WAK tigSpeed.....	11
5.3	Final assembly.....	13
6	Technical data	13
6.1	ON WAK xx5.....	13
6.2	ON WAK tigSpeed.....	13

2 Safety instructions

DANGER



- Do not carry out any unauthorised repairs or modifications!**
To avoid injury and equipment damage, the unit must only be repaired or modified by specialist, skilled persons!
The warranty becomes null and void in the event of unauthorised interference.
- Appoint only skilled persons for repair work (trained service personnel)!

WARNING



- Validity of this document!**
This document is only valid in combination with the operating instructions for the power source being used (welding machine)!
- Read the operating instructions, in particular the safety instructions for the power source (welding machine)!



- Risk of accidents if these safety instructions are not observed!**
Non-observance of these safety instructions is potentially fatal!
- Carefully read the safety information in this manual!
 - Observe the accident prevention regulations in your country.
 - Inform persons in the working area that they must observe the regulations!

CAUTION



- Obligations of the operator!**
The respective national directives and laws must be observed for operation of the machine!
- National implementation of the framework directive (89/391/EEG), as well as the associated individual directives.
 - In particular, directive (89/655/EEG), on the minimum regulations for safety and health protection when staff members use equipment during work.
 - The regulations regarding work safety and accident prevention for the respective country.
 - Setting up and operating the machine according to IEC 60974-9.
 - Check at regular intervals that users are working in a safety-conscious way.
 - Regular checks of the machine according to IEC 60974-4.

3 Overview

3.1 Proper usage

WARNING



Hazards due to improper usage!

Hazards may arise for persons, animals and material objects if the equipment is not used correctly. No liability is accepted for any damages arising from improper usage!

- The equipment must only be used in line with proper usage and by trained or expert staff!
- Do not modify or convert the equipment improperly!

CAUTION



Risk of accidents due to improperly prepared transport vehicle!

Depending on the machine series the transport vehicle has to be adapted to mount the machine. Failing to adapt the transport vehicle can cause the machine being transported to topple and lead to injuries!

The ON WAK and ON WAK tigSpeed transport systems are suitable for:

- moving the machines and machine combinations listed,
- moving properly fixed machines and add-on parts that are suitably secured.

Any other use of the transport systems is regarded as "improper" and no liability is assumed for any damage arising therefrom.

3.1.1 ON WAK xx5

Power source

- Picomig 305 puls D3
- Taurus 355, 405, 505 TDM
- Phoenix 355, 405, 505 TDM

Cooling unit

- cool50 U40
- cool50-2 U40

3.1.2 ON WAK tigSpeed

- tigSpeed drive 45 coldwire
- tigSpeed drive 45 hotwire

3.2 Example applications

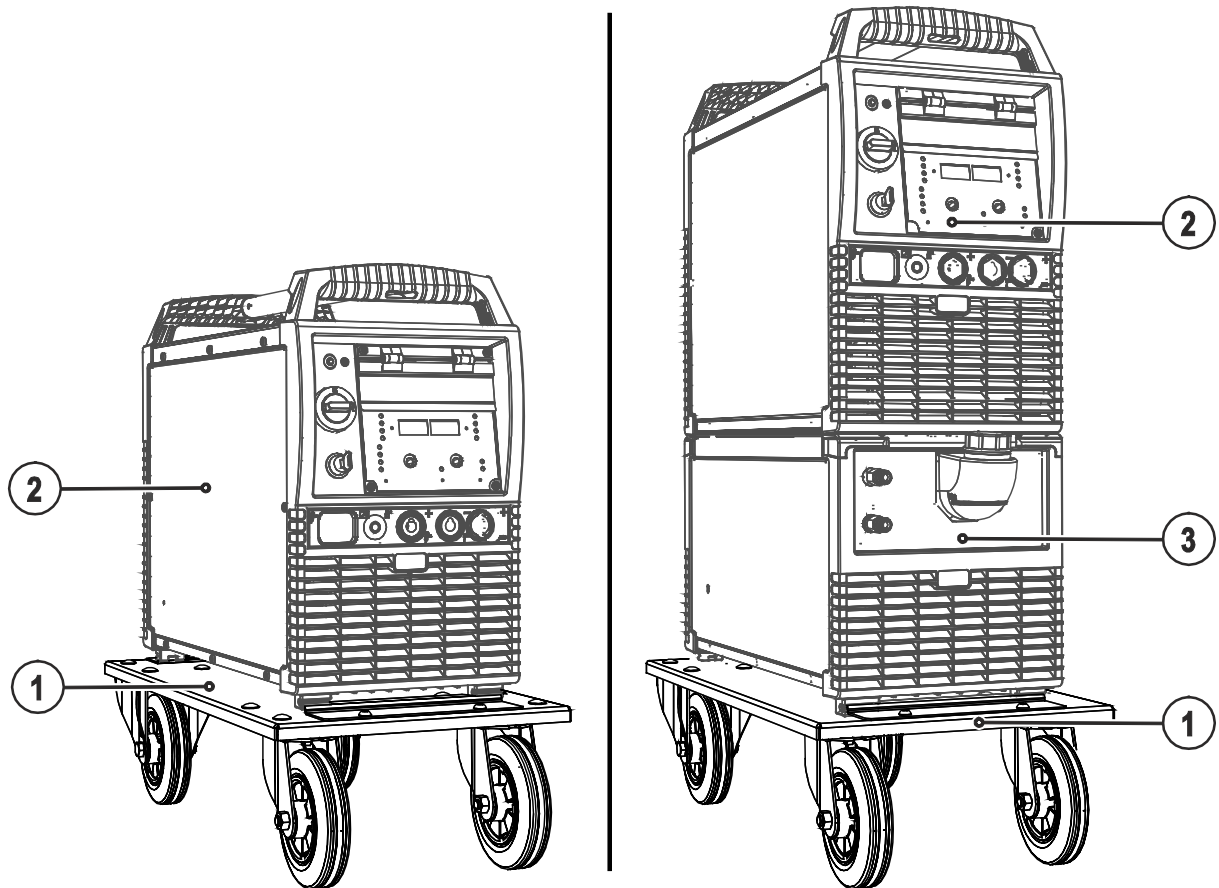

Figure 3-1

Item	Symbol	Description
1		Transport vehicle (option)
2		Power source / Wire feeder
3		Cooling unit

4 Machine description – quick overview

4.1 ON WAK xx5

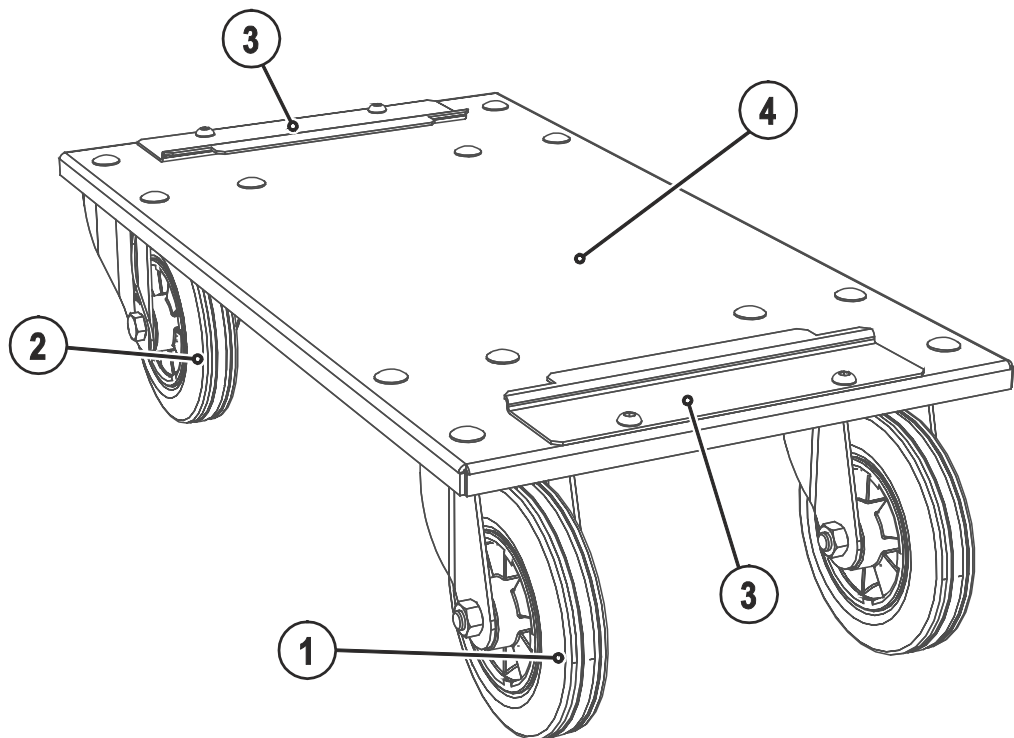

Figure 4-1

Item	Symbol	Description
1		Wheels, guide castors
2		Wheels, fixed castors
3		Machine mounting attachment
4		Machine carrier plate

4.2 ON WAK tigSpeed

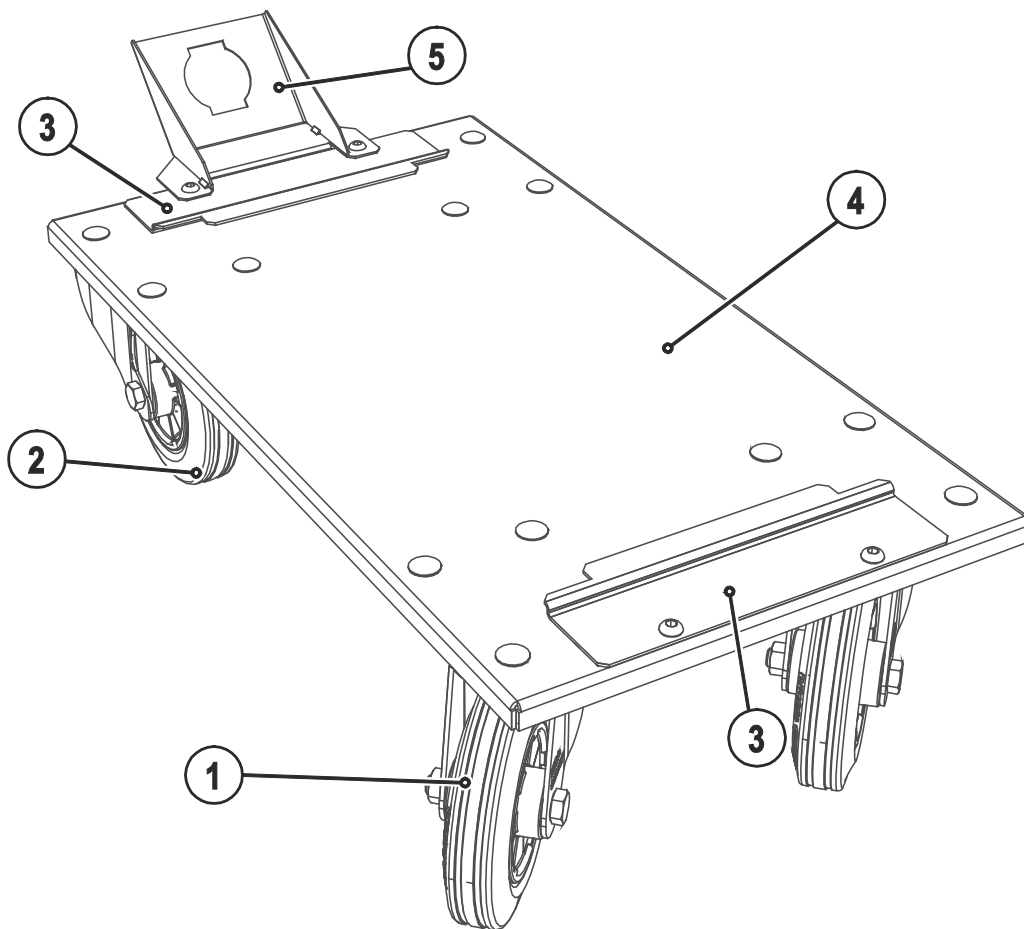

Figure 4-2

Item	Symbol	Description
1		Wheels, guide castors
2		Wheels, fixed castors
3		Machine mounting attachment
4		Machine carrier plate
5		Strain relief

5 Assembly

5.1 ON WAK xx5

⚠ CAUTION



Improperly secured equipment!

Equipment, equipment combinations and accessories incorrectly fastened onto transport systems can tip over during transport and cause injuries!

- Only use the original parts supplied to fasten the equipment.
- Use the systems only for transporting the machines given in the "Intended use" chapter.
- Check the fixing points before each transport and at regular intervals.

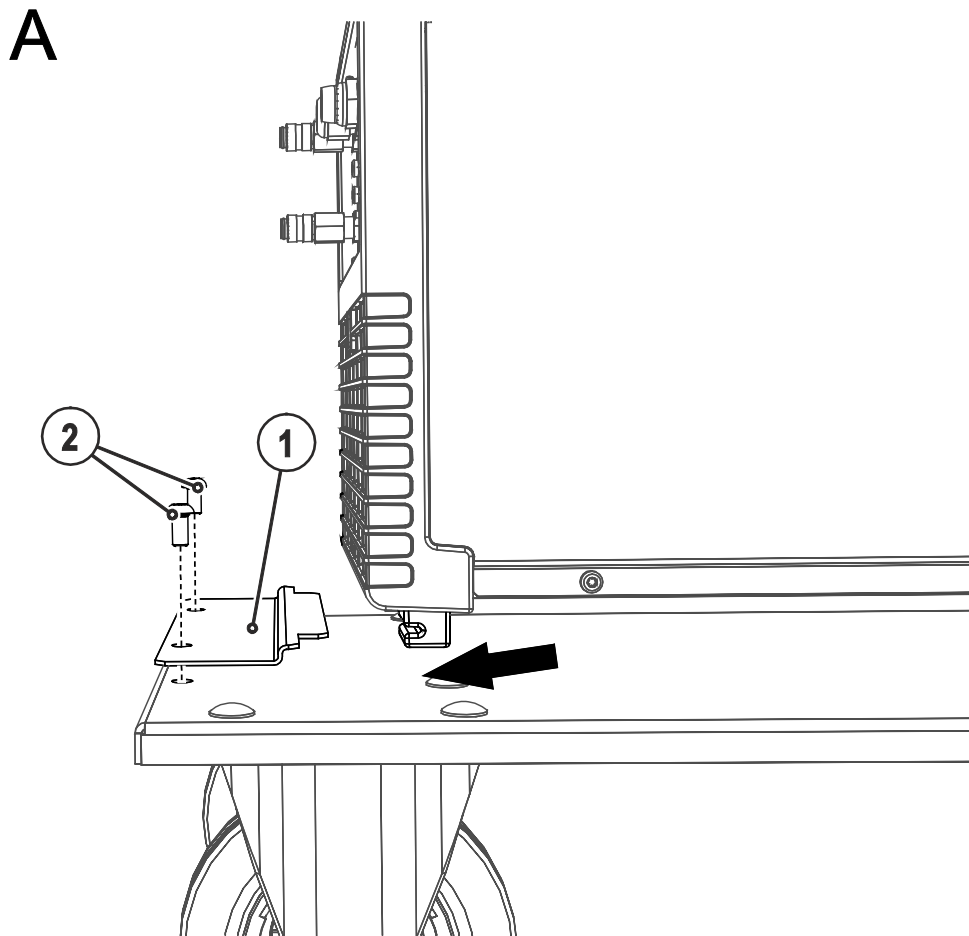

Figure 5-1

B

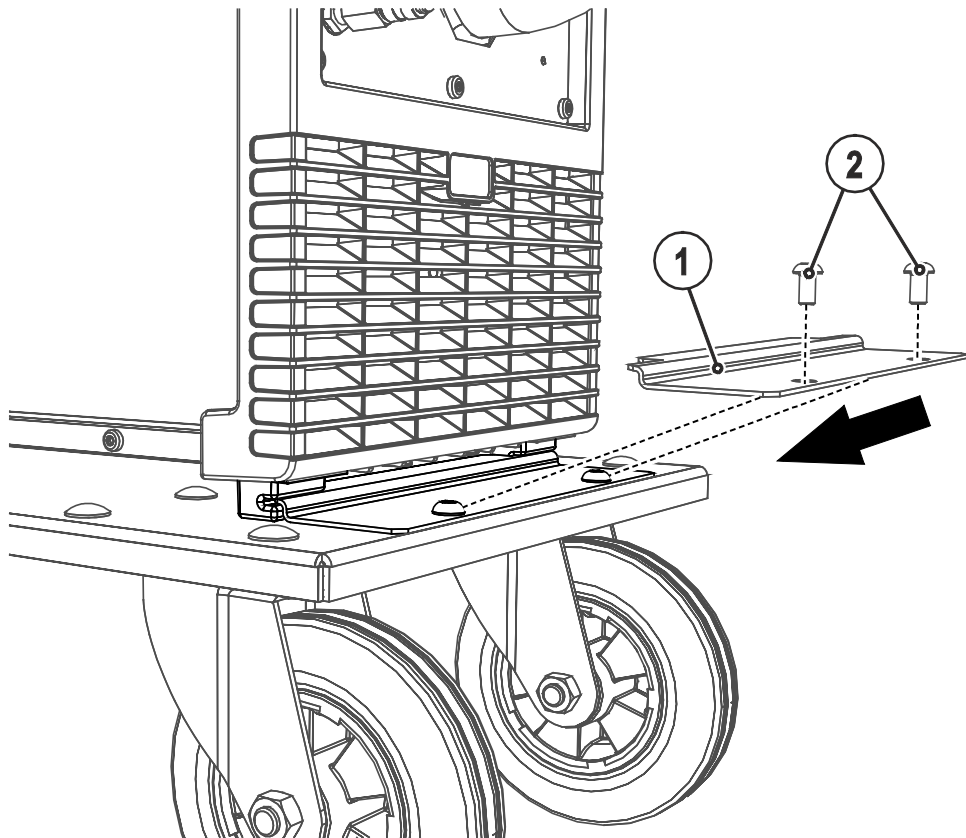

Figure 5-2

Item	Symbol	Description
1		Machine mounting attachment
2		Flat head screw

- Place and fix the machine on the carrier plate.

5.2 ON WAK tigSpeed

⚠ CAUTION**Improperly secured equipment!**

Equipment, equipment combinations and accessories incorrectly fastened onto transport systems can tip over during transport and cause injuries!

- Only use the original parts supplied to fasten the equipment.
- Use the systems only for transporting the machines given in the "Intended use" chapter.
- Check the fixing points before each transport and at regular intervals.

A

Figure 5-3

B

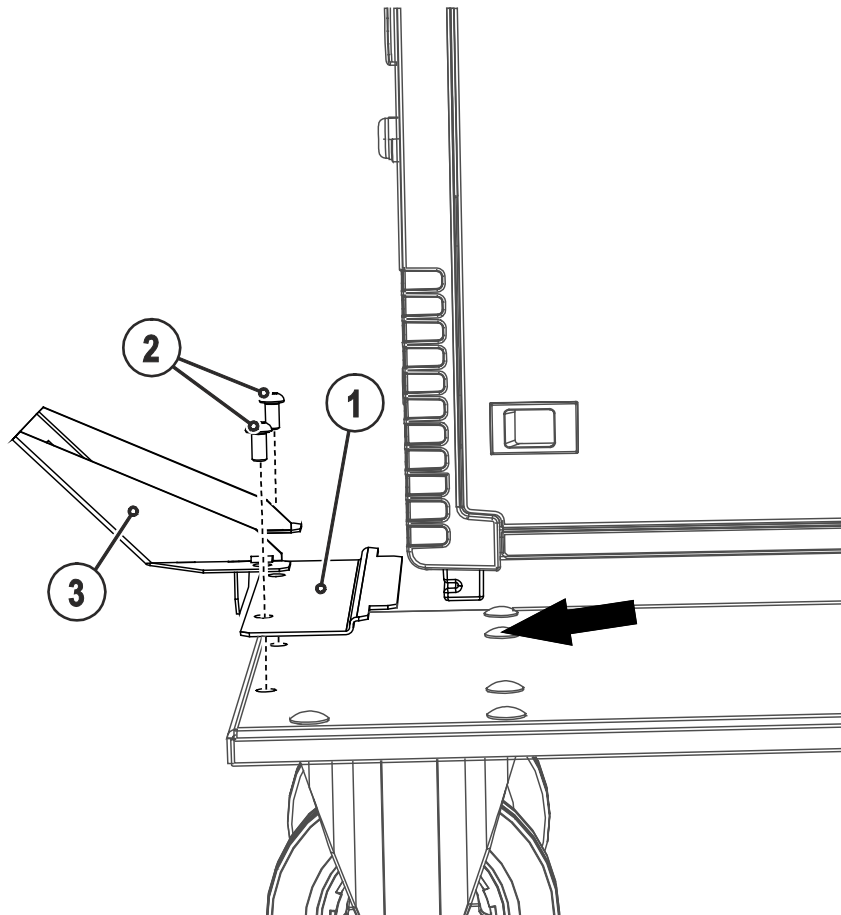
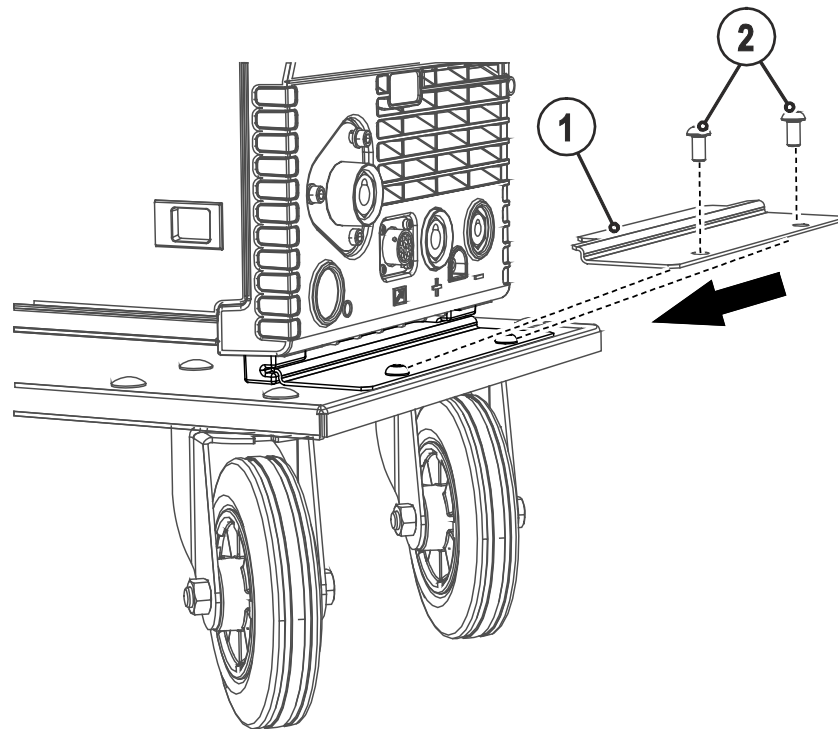

Figure 5-4

Item	Symbol	Description
1		Machine mounting attachment
2		Flat head screw
3		Strain relief

- Place and fix the machine on the carrier plate.
- Attach the strain relief with the machine mounting attachment to the carrier plate using two M8 x 16 screws.

5.3 Final assembly

WARNING



Danger due to failure to carry out the final inspection!

Parts that are incorrectly fitted or that become loose are a source of danger.

- Check all mechanical connections to ensure that they are fitted correctly!
- Carry out the final inspection!
- Carry out the functional test!

NOTE



- Keep the conversion instructions with the machine documentation!
- When ordering spare parts, ensure that the item number and serial number of the machine are quoted!

6 Technical data

6.1 ON WAK xx5

Dimensions (LxWxH) in mm	750 x 385 x 208
Weight without accessories	Approx. 16 kg
Constructed to standard	IEC 60974-1

6.2 ON WAK tigSpeed

Dimensions (LxWxH) in mm	864 x 385 x 276
Weight without accessories	Approx. 16,4 kg
Constructed to standard	IEC 60974-1