



**EN**

## Retrofit option

### ON WAKD 4L/41L

Wheel assembly kit

099-008169-EW501

Observe additional system documents!

26.06.2017

**Register now  
and benefit!  
Jetzt Registrieren  
und Profitieren!**

[www.ewm-group.com](http://www.ewm-group.com)



## General instructions

### WARNING



#### **Read the operating instructions!**

**The operating instructions provide an introduction to the safe use of the products.**

- Read and observe the operating instructions for all system components, especially the safety instructions and warning notices!
- Observe the accident prevention regulations and any regional regulations!
- The operating instructions must be kept at the location where the machine is operated.
- Safety and warning labels on the machine indicate any possible risks. Keep these labels clean and legible at all times.
- The machine has been constructed to state-of-the-art standards in line with any applicable regulations and industrial standards. Only trained personnel may operate, service and repair the machine.
- Technical changes due to further development in machine technology may lead to a differing welding behaviour.



***In the event of queries on installation, commissioning, operation or special conditions at the installation site, or on usage, please contact your sales partner or our customer service department on +49 2680 181-0.***

***A list of authorised sales partners can be found at [www.ewm-group.com](http://www.ewm-group.com).***

Liability relating to the operation of this equipment is restricted solely to the function of the equipment. No other form of liability, regardless of type, shall be accepted. This exclusion of liability shall be deemed accepted by the user on commissioning the equipment.

The manufacturer is unable to monitor whether or not these instructions or the conditions and methods are observed during installation, operation, usage and maintenance of the equipment.

An incorrectly performed installation can result in material damage and injure persons as a result. For this reason, we do not accept any responsibility or liability for losses, damages or costs arising from incorrect installation, improper operation or incorrect usage and maintenance or any actions connected to this in any way.

© EWM AG

**Dr. Günter-Henle-Straße 8**

**56271 Mündersbach**

**Germany**

The copyright to this document remains the property of the manufacturer.

Copying, including extracts, only permitted with written approval.

The content of this document has been prepared and reviewed with all reasonable care. The information provided is subject to change; errors excepted.

## 1 For your safety

### 1.1 Safety instructions

#### WARNING



**Do not carry out any unauthorised repairs or modifications!**

**To avoid injury and equipment damage, the unit must only be repaired or modified by specialist, skilled persons!**

**The warranty becomes null and void in the event of unauthorised interference.**

- Appoint only skilled persons for repair work (trained service personnel)!



**Risk of accidents due to non-compliance with the safety instructions!**

**Non-compliance with the safety instructions can be fatal!**

- Carefully read the safety instructions in this manual!
- Observe the accident prevention regulations and any regional regulations!
- Inform persons in the working area that they must comply with the regulations!



***This document is valid only in combination with the operating instructions for the product being used!***

- ***Read and observe the operating instructions for all system components, especially the safety instructions!***

## 2 Intended use

### 2.1 General

#### WARNING



**Hazards due to improper usage!**

**The machine has been constructed to the state of the art and any regulations and standards applicable for use in industry and trade. It may only be used for the welding procedures indicated at the rating plate. Hazards may arise for persons, animals and material objects if the equipment is not used correctly. No liability is accepted for any damages arising from improper usage!**

- The equipment must only be used in line with its designated purpose and by trained or expert personnel!
- Do not improperly modify or convert the equipment!

### 2.2 Applications

Use the option described below to add a wheel set to a wire feeder.

These instructions apply only for the conversion of the following machines:

- Pico drive 4L
- Saturn M1.02 drive 41L
- Saturn M2.20 drive 41L
- Saturn M2.40 drive 41L
- Taurus drive 4L Basic
- Tatrix drive 4L
- Wega M1.02 drive 41L
- Wega M2.20 drive 41L
- Wega M2.40 drive 41L

### 2.3 Short description of the working steps required

- Prepare the wire feeder
- Install the wheel assembly kit
- Perform final inspection

## 3 Conversion

### 3.1 General

#### **⚠ DANGER**



**Risk of injury from electric shock!**

**Servicing machines that are not disconnected from the mains can lead to serious injuries!**

- Disconnect the machine completely from the mains.  
Pull out the mains plug!
- Wait for 4 minutes until the capacitors have discharged!

### 3.2 Parts list



**Before conversion, check that the retrofit kit is complete (see parts list).**

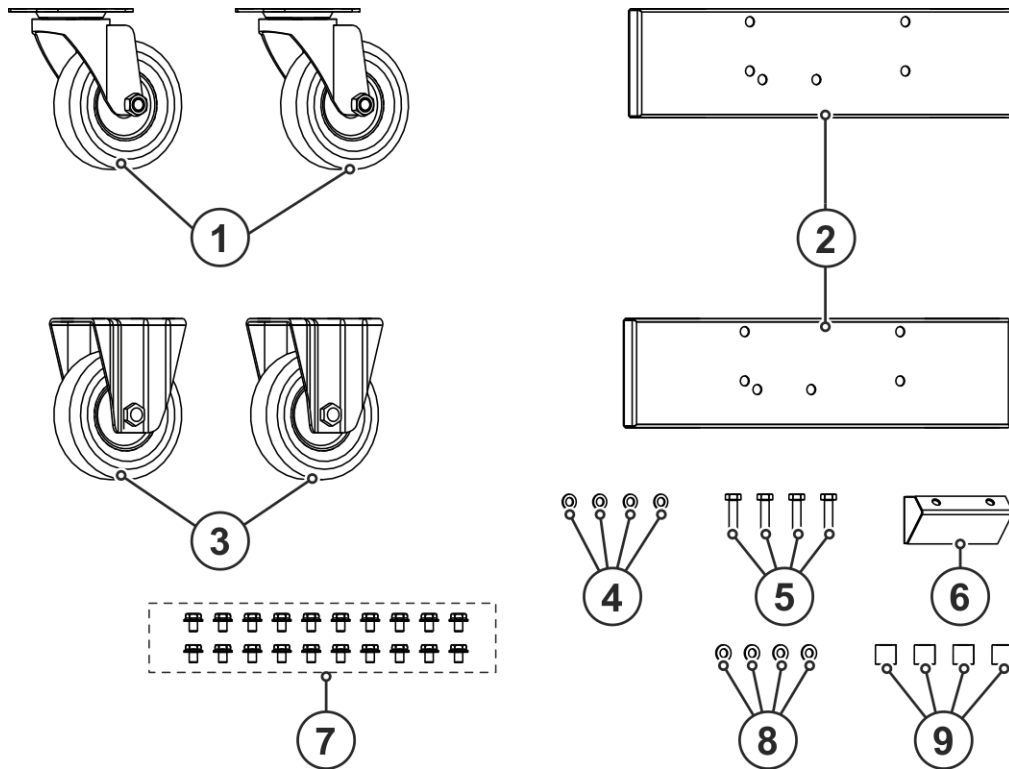

Figure 3-1

Item	Quantity	Description	Item number
1	2	Guide castor	094-000181-00000
2	2	Support plate	094-008065-00000
3	1	Fixed castor	094-003067-00000
4	4	<b>M8 plain washer</b>	<b>064-000586-00000</b>
5	4	M8 X 30, Hexagonal screw	064-000698-00000
6	1	Connecting panel	094-008064-00001
7	20	M8 x 10, hexagonal screw	064-000654-00000
8	4	<b>M8 spring washer</b>	<b>064-000596-00000</b>
9	4	Distance roller	094-008116-00000

## 3.3 Assembly

## 3.3.1 Preparing the wire feeder

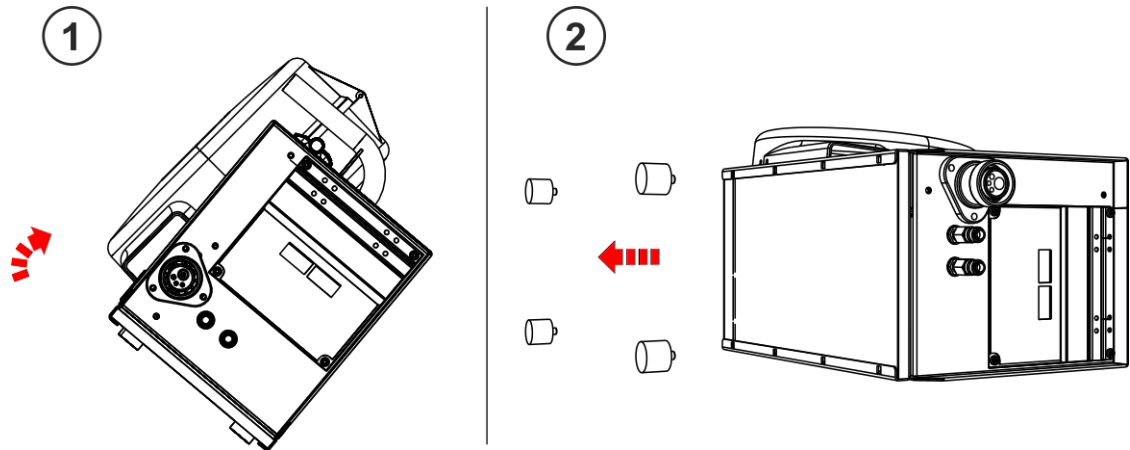

Figure 3-2

- Disconnect the wire feeder from the power source.
- Remove the wire spool from the wire feeder.
- Place the wire feeder on its side as shown.
- Unscrew and remove the machine feet.

## 3.3.2 Installing the wheel assembly kit

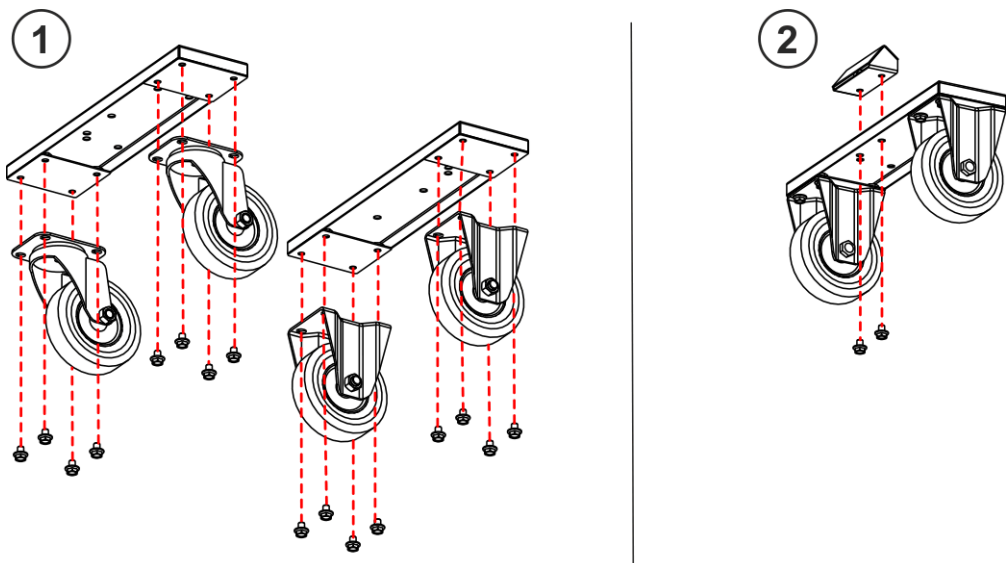

Figure 3-3

- Screw the fixed and guide castors to the support plates using M8 x 10 hexagonal screws.
- Screw the connecting panel to the support plate with fixed castors using M8 x 10 hexagonal screws.

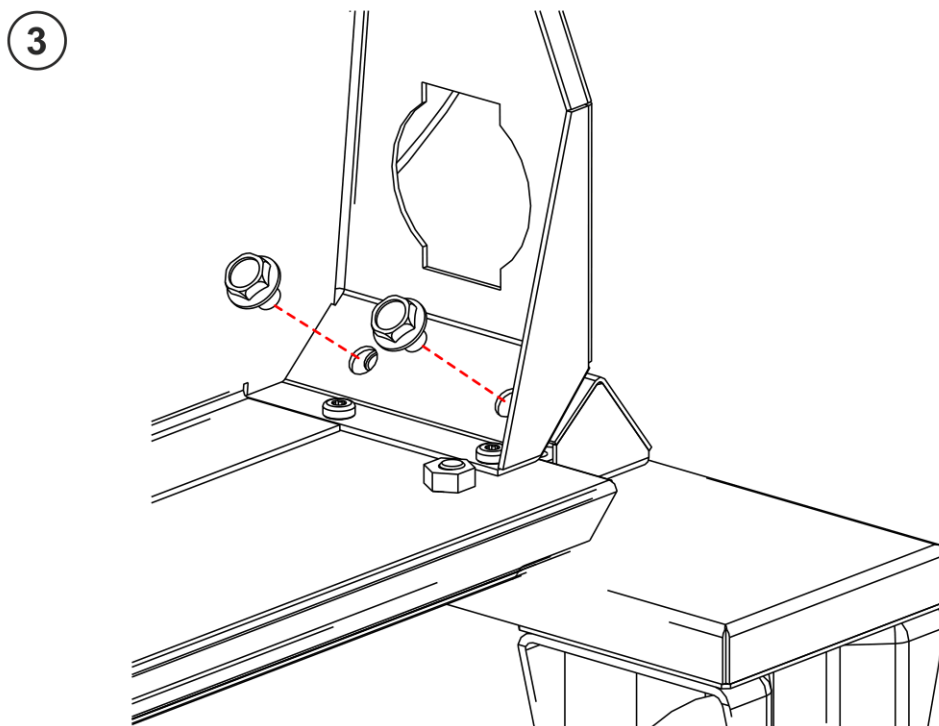
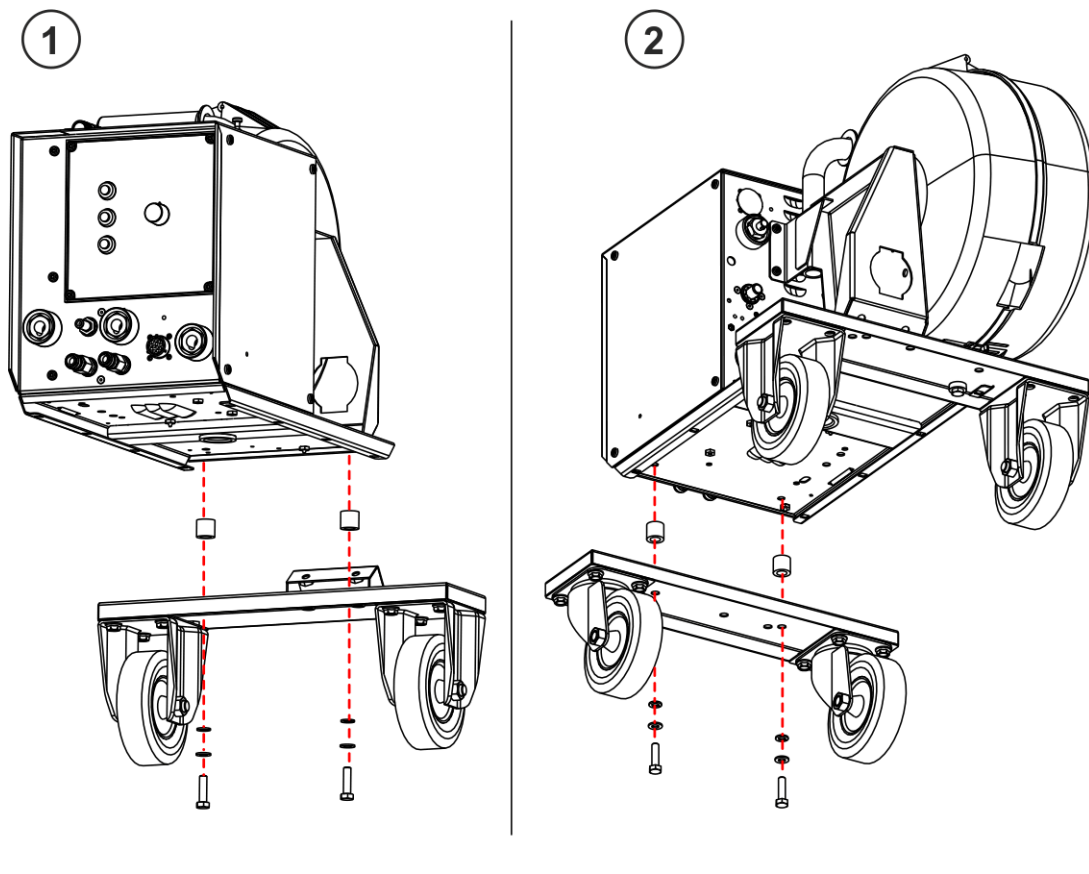

Figure 3-4

- Plug the M8 plain washers and M8 spring lock washers onto the M8 x 30 hexagonal screws.
- Screw the support plate to the machine feet recesses of the wire feeder using M8 x 30 hexagonal screws and distance rolls as shown.
- Screw the wire feeder to the connecting panel using M8 x 10 hexagonal screws.

### 3.4 Final inspection

#### **WARNING**



**Danger due to failure to carry out the final inspection!**

**Parts that are incorrectly fitted or that become loose are a source of danger.**

- Check all mechanical connections to ensure that they are fitted correctly!
- Carry out the final inspection!
- Carry out the functional test!



***Keep the conversion instructions with the machine documentation!***

***When ordering spare parts, ensure that the item number and serial number of the machine are quoted!***